

BUILT TO RESIST

APPLICATION

# Electronic controller

## BENEFITS

- Closed loop
- Signal and not power electronics (simplified switchboard)
- Normal electric motor, rotates at fixed speed (no servo-ventilation), little stress
- The power part stays on the variator:
  - wide speed range (0-1500 rpm)
  - high torques at low revolutions
- Suitable for difficult, humid and dusty environments
- Precise speed control about 1 rpm

### CLOSED-LOOP OPERATION

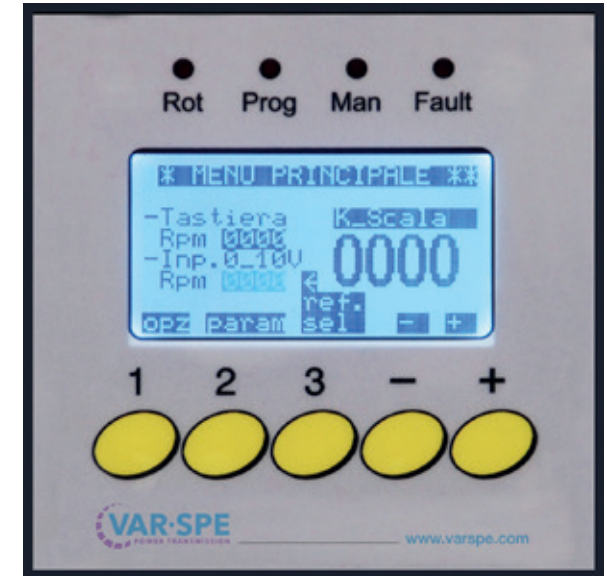
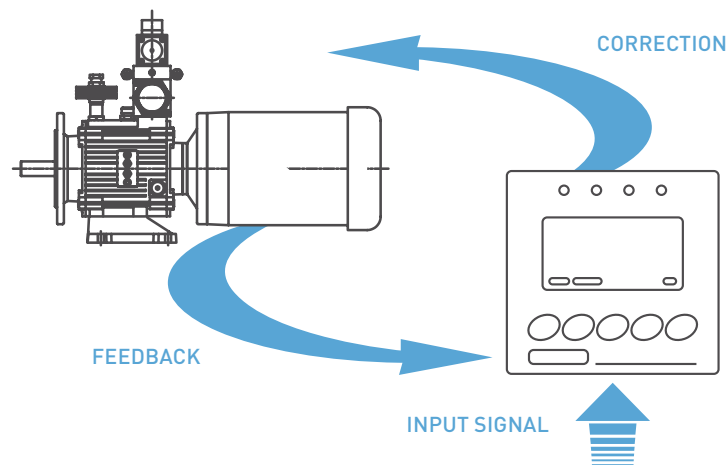

## CHARACTERISTICS

- Inputs:
  - 4-20mA / 0-20mA
  - 0-10V / 0-5V
  - potentiometer
  - Keypad
  - 4 digital inputs
- Power supply 24Vdc or 24Vac
- Wide display
- Speed display through scale factor
- Acceleration and deceleration ramps
- Alarm (bypassable)



BUILT TO RESIST



- HARD ENVIRONMENTS
- LONG SERVICE LIFE
- RELIABILITY



PRODUCT RANGE



**K2** (0,37-0,55-0,75 kW)



**K4** (1,1-1,5 kW)



**K5** (2,2-3-4 kW)



**15** (3-4 kW)



**16** (5,5-7,5 kW) **16B** (11 kW)



**17** (15 kW) **17B** (22 kW)



**Atex-certified variators**  
(0,37-22 kW)

VAR-SPE SRL  
Via Cordellina, 81 36077 Altavilla Vicentina (VI) Italia

Tel. +39 0444 572.011  
Fax +39 0444 573.188

www.varspe.com  
info@varspe.com